

86-OPER-PC – PC, touch monitor and TE10-41/1

PRODUCT SHEET

IHM provides various versions of an operator position with the desk top terminal, which are differentiated by the size of the monitor:

- 86-Oper-PC1 – monitor size: 10,1”
- 86-Oper-PC2 – monitor size: 15,6”
- 86-Oper-PC3 – monitor size: 22”

For all 3 versions, the 86-Oper-PC 1/2 and 3 are an Operator positions used with IHM switches and applications as for example the IHM-MCS IP FLEXIBLE. The positions are made for users who requires a rugged desktop terminal.

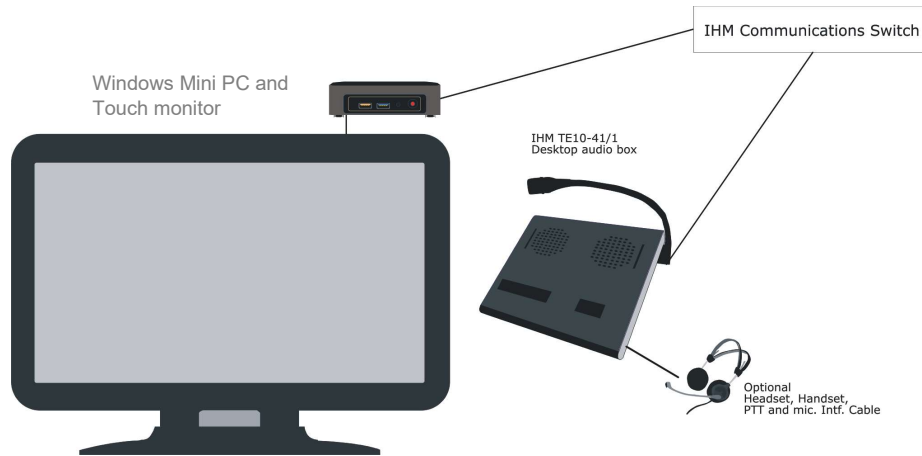

Thus, the 86-OPER-PC1/2/3 operator position consist of a Windows mini-PC (SFF), a 10,1”, 15,6” respectively 22” touch monitor and an IHM TE10-41/1 desktop audio terminal which includes a gooseneck microphone and built-in loudspeakers for both traffic and monitor channels.

Operator PC

Touch display and power adapter



HDMI cable

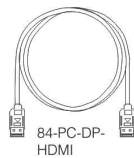

USB device cable

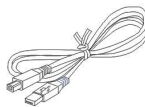

Mini Windows PC and power adapter
84-PC-BASIS14

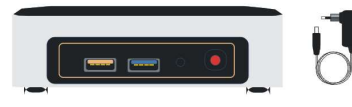

LAN cable
69-00-05/3



TE10-41 Operator desktop terminal

TE10-41/1



Kettle lead
60-60-00



LAN cable
69-00-05/3



86-OPER-PC – PC, touch monitor and TE10-41/1

PRODUCT SHEET

The Operator PC with Windows OS provides the GUI for the Dispatcher, whereas the TE10-41/1 desktop unit provides the audio to the Dispatcher. The desktop terminal holds built-in speakers for both traffic and monitored channels as well as volume sliders for the loudspeakers and for the headset/handset. Further, the desktop terminal includes a gooseneck microphone and a large PTT button. The terminal also holds sockets for connection of the optional headset, handset/cradle, foot operated PTT and interface cable for a Motorola hand microphone.

Installation

For installation, follow the drawings below.

Please note that both the PC and the TE10-41 are to be interconnected to the IHM Flexible switch via LAN.

PC Installation

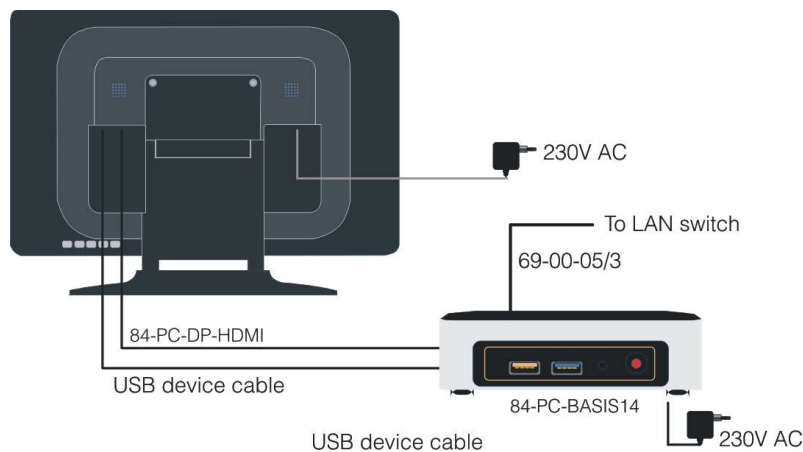

TE10-41 Installation

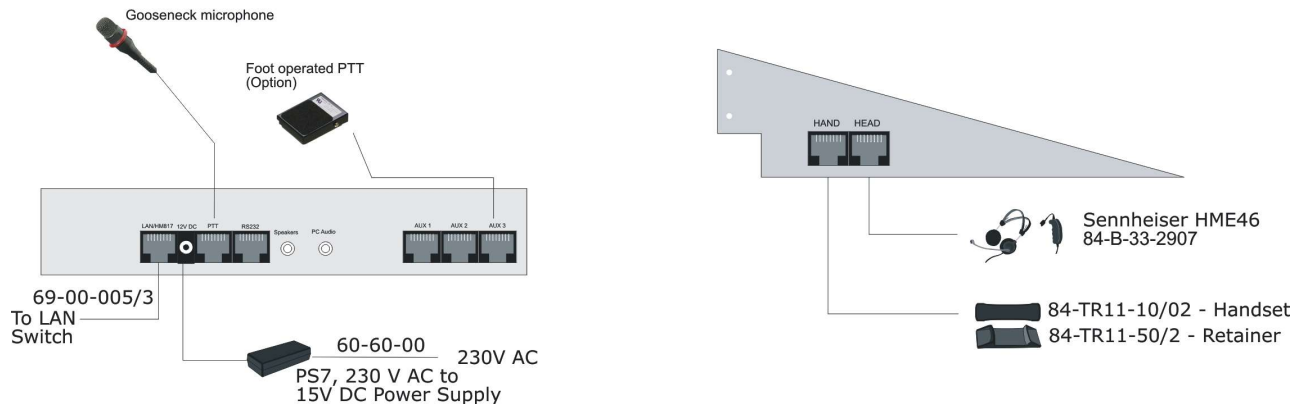



86-OPER-PC – PC, touch monitor and TE10-41/1

PRODUCT SHEET**Technical data**

| Product no | Components | Connectors | Dimensions | Weight |
|-----------------------------------|--------------------------|--|--|-----------------------------|
| 86-TE10-41/1 | IHM TE10-41/1 | | | |
| | | RJ45 to LAN DC plug for 230V Adapter with C13 socket RJ45 for headset, handset and PTT | 250x130x75mm Shipping 240x130x335mm | 1kg Shipping 1,7kg |
| 84-PC-BASIS14 | Intel NUC miniPC | | | |
| | | RJ45 to LAN DC plug for 230V Adapter with C13 socket USB x 3, HDMI for monitor | 115x115x35mm Shipping 130x140x100mm | ,45kg Shipping 1,0 kg |
| 84-PC-MONITOR (to be selected) | Elo Touch Monitor | | | |
| 84-PC-MONITOR20 | 10,1" | HDMI for display, USB for touch and DC plug for the power adapter | 255x177x29 Shipping 310x240x140mm | 0,8kg Shipping 2kg |
| 84-PC-MONITOR21 | 15,6" | HDMI for display, USB for touch and DC plug for the power adapter | 390x245x33mm Shipping 460x350x180mm | 3kg Shipping 5,1kg |
| 84-PC-MONITOR22 | 21,5" | HDMI for display, USB for touch and DC plug for the power adapter | 551x193x392mm Shipping 252x419x572mm | 7,5kg Shipping 12,5kg |

| Other specifications | Notes | |
|----------------------|---|--|
| Power supply | Voltage Consumption and heat dissipation maximum | 230V AC 66W |
| Temperature range | Operating Storage Long term storage | 10°C to +30°C -10° to +40°C 0°C to +35°C |
| Humidity | Non-condensing | 20-80% relative humidity |
| EMC | | EN55032 EN55024 |
| MTBF | Depends on optional components included | + 60.000h |





86-OPER-PC – PC, touch monitor and TE10-41/1

PRODUCT SHEET

Optional components

Optionally, the Operator position can be delivered with a wired stereo headset, a handset with built-in PTT-button and retainer, and a foot operated PC or an interface cable for a Motorola hand microphone.

Please note: Keyboard and mouse are not included in this kit as they are not required for normal operation of IHM MCS series operator software, where you use the touch screen monitor instead.

| | | | |
|---|---|--|---|
|  |  |  |  |
| 84-B-33-2907 Sennheiser stereo headset with PTT | 84-TR11-10/2 Handset & 84-TR11-50/2 Cradle | 84-B-34-9901/2 Foot operated switch w/20cm pad | 69-18-006 Adapter cable for Motorola microphone |